

CENTRADA

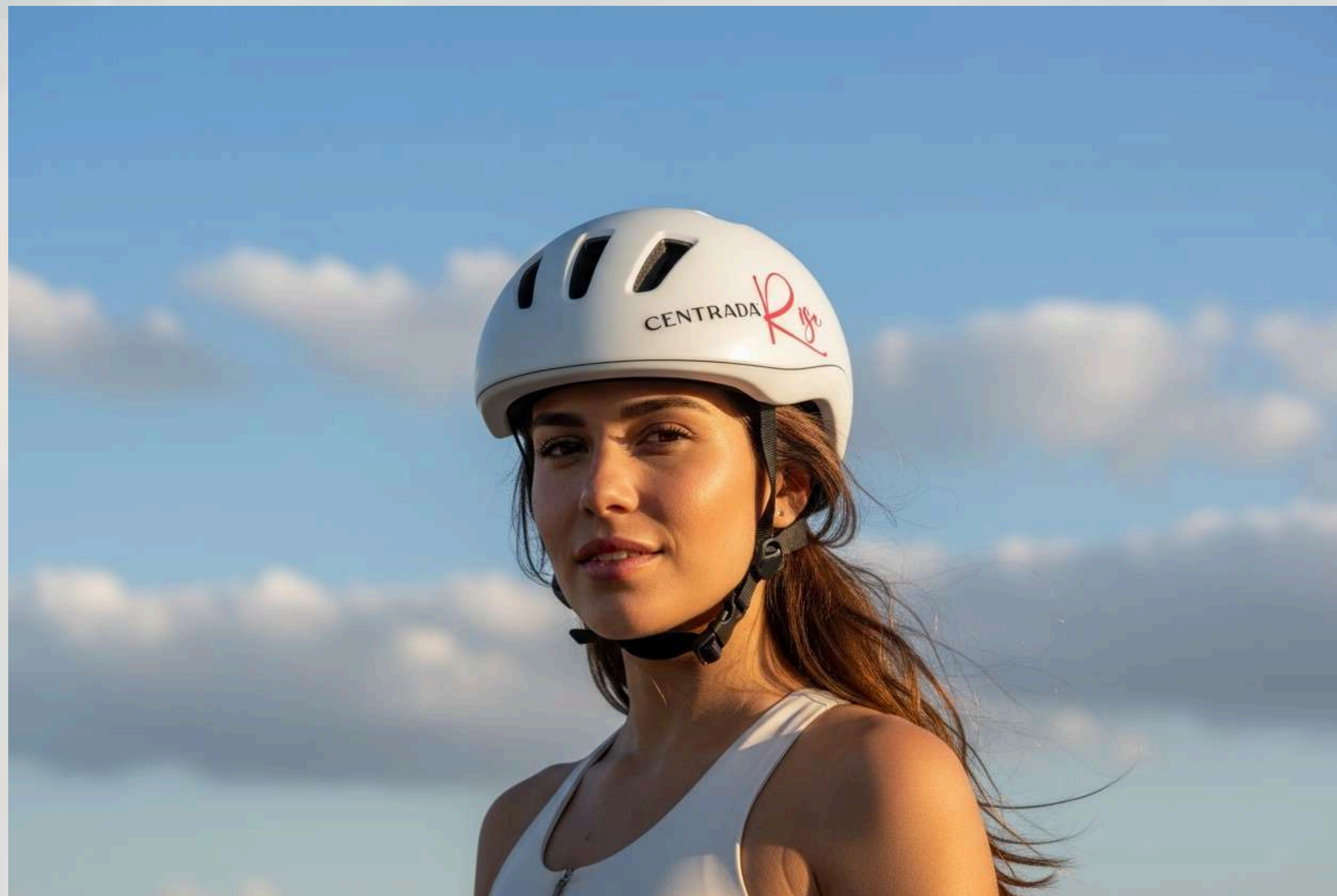

*Elevate your lifestyle*



Above the city.  
Beyond  
expectations.

Elevate your life where every moment feels lighter, calmer, and more meaningful. At CentradaRise, life unfolds at a higher rhythm — where spaces breathe, time slows down, and everyday moments turn into experiences worth remembering. It's a place designed to lift your spirit, inspire your days, and gently remind you that life can always be lived a little higher, a little better.



# CENTRADA™

## DEVELOPMENTS

CENTRADA  
*Plaza*

وسط البلدية  
مجمع تجاري وإداري وطني

CENTRADA  
*hub*

CENTRADA  
*One*

**kite.** RESIDENCE

**kite.** WORK &  
LIFE COMPLEX

**Belong**™  
VILLA COMMUNITY

**NINE**  
**NR**

**C9**

CENTRADA *Rise*

We Are More Than  
Developers

At Centrada , we bring extraordinary visions to life by harnessing the glory of natural landscapes and modern innovations to create pioneering sustainable and impactful developments.

We design to make a difference and foster happiness. We embrace creativity, innovation, sustainability and harmony.



# NARRATIVE

COMMUNITIES

Narrative Communities is a comprehensive real estate platform. We develop residential communities, commercial districts, administrative buildings, and mixed-use lifestyle destinations. Our spaces are cultured, warm, socially intelligent, and quietly luxurious.

[ARCHIVE](#)

[Brand](#)

[Philosophy](#)



# INTRO

CentradaRise stands at one of the highest and most distinguished locations in West Cairo, with a breathtaking open view over Sheikh Zayed ,palm hills and Beverly Hills. It is a thoughtfully designed mixed-use destination that brings together business, administration, and medical services in an elevated environment built for growth, visibility, and long-term value.





# Creating Landmarks. Changing Skylines.

CentradaRise stands as the new icon of 6th of October — a bold destination rising above the city, where business, lifestyle, and modern design come together.

Strategic  
Location



SHEIKH ZAYED CITY



26TH OF JULY CORRIDOR

PALM HILLS SQUARE

CENTRADA *Rise*

ABU SHAQRA MOSQUE



# LAND MARKS

- Direct access to 26th of July Axis
  - Minutes from Al Wahat Road
  - Close to Central Axis (Al Mehwar Al Markazy)
- 
- Palm Hills Square – 2–3 minutes
  - Beverly Hills – 5–7 minutes
  - Juhayna Square – 7–10 minutes
  - Mall of Arabia – 10 minutes
  - El Hosary Square – 10–15 minutes

# VISION STATEMENT

Designed for Flow. Built for Performance.  
CentradaRise blends visibility, circulation,  
and functional planning to create an  
efficient hub for business owners,  
entrepreneurs, and brands seeking a  
high-impact address.



A flock of approximately 20 birds is flying in a loose circular pattern against a light, hazy sky. The birds are captured in various stages of flight, with wings spread, creating a sense of movement and a circular flow.

# PROJECT NUMBER

CentradaRise in numbers

- \*Total land area:\* 9.39 Acres
- \*No. Of Commercial units:\* 370
- \*No. Of Administrative units:\* 190
- \*No. Of Medical units:\* 282
- \*Floors:\* Ground+3
- \*Parking spaces:\* 890
- \*Frontage width:\* 71 meters



# ADMINISTRATIVE ZONE

Smart Offices. Productive Spaces.

- Flexible office modules
- Natural daylight
- Acoustic comfort
- Premium finishes
- Separate entrances & elevators

Ideal for:

Consulting, Creative offices, Technology,  
Corporate setups.



# MEDICAL ZONE

A Healthcare Destination with Modern Standards

- Clinics with private entrances
- Spacious waiting areas
- Medical-grade circulation
- Easy patient drop-off
- High visibility for branding



# COMMERCIAL ZONE DESCRIPTION

## The Commercial Spine

- High-visibility storefronts
- Double-height shopfronts
- Heavy footfall
- Outdoor circulation
- F&B terraces
- Drive-thru-ready access

Ideal for:

Cafés, Restaurants, Retail, Pharmacies, Services.



# Elevate Your Soul, Beyond the Ordinary

Step into Centrada Rise, a destination meticulously designed for those who dare to dream and seek to unwind amidst the clouds. It is far more than a commercial hub; it is a celestial sanctuary where you can rise above the daily hustle and float in a world of luxury. Whether you are lounging on our F&B terraces—feeling as though you’re dining in the sky—or exploring our high-visibility storefronts that radiate elegance, every moment is a journey toward joy. At Centrada Rise, we offer you the perfect space to create unforgettable memories while experiencing a true sense of freedom and elevation.

# AMENITIES & SERVICES

Everything Your Business Needs

- Security 24/7
- Facility management
- Housekeeping services
- Fire safety & emergency systems
- Underground & outdoor parking
- ATM zone
- Pharmacy access
- Loading docks



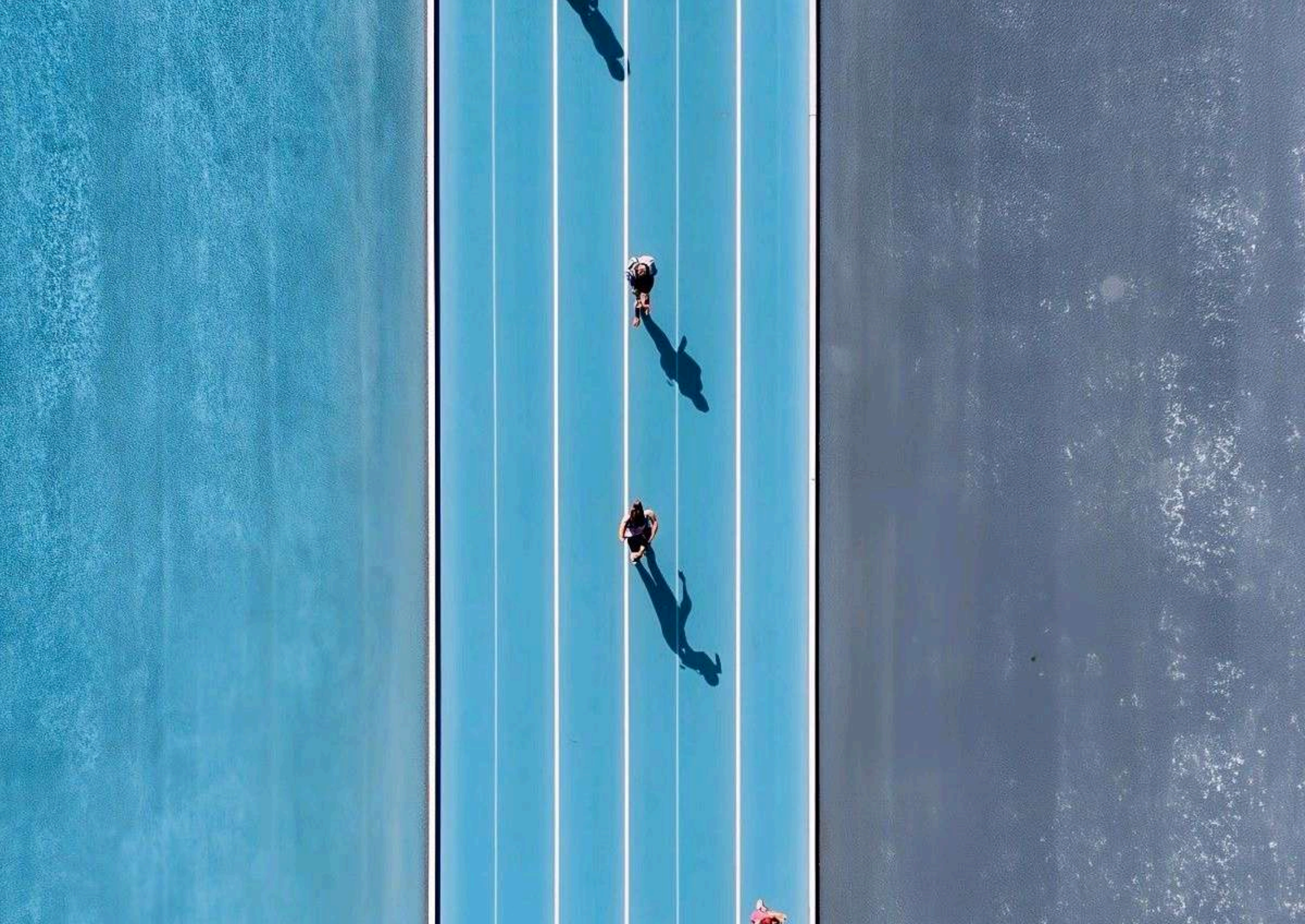

# LANDSCAPE & PUBLIC REALM

Where People Gather, Meet & Connect

- Pedestrian-friendly plaza
- Outdoor seating
- Green pockets
- Iconic Rise installations
- Celebration of open spaces & natural light



# CIRCULATION & MOBILITY

Designed for Efficiency

- Clear pedestrian routes
- Service corridors
- Vehicle drop-off loops
- Smart access points
- Loading/unloading designed away from public circulation



CENTRADA™

*Rise*



Find your  
space,  
find your  
success at  
Centrada Rise.



























PLANNERS

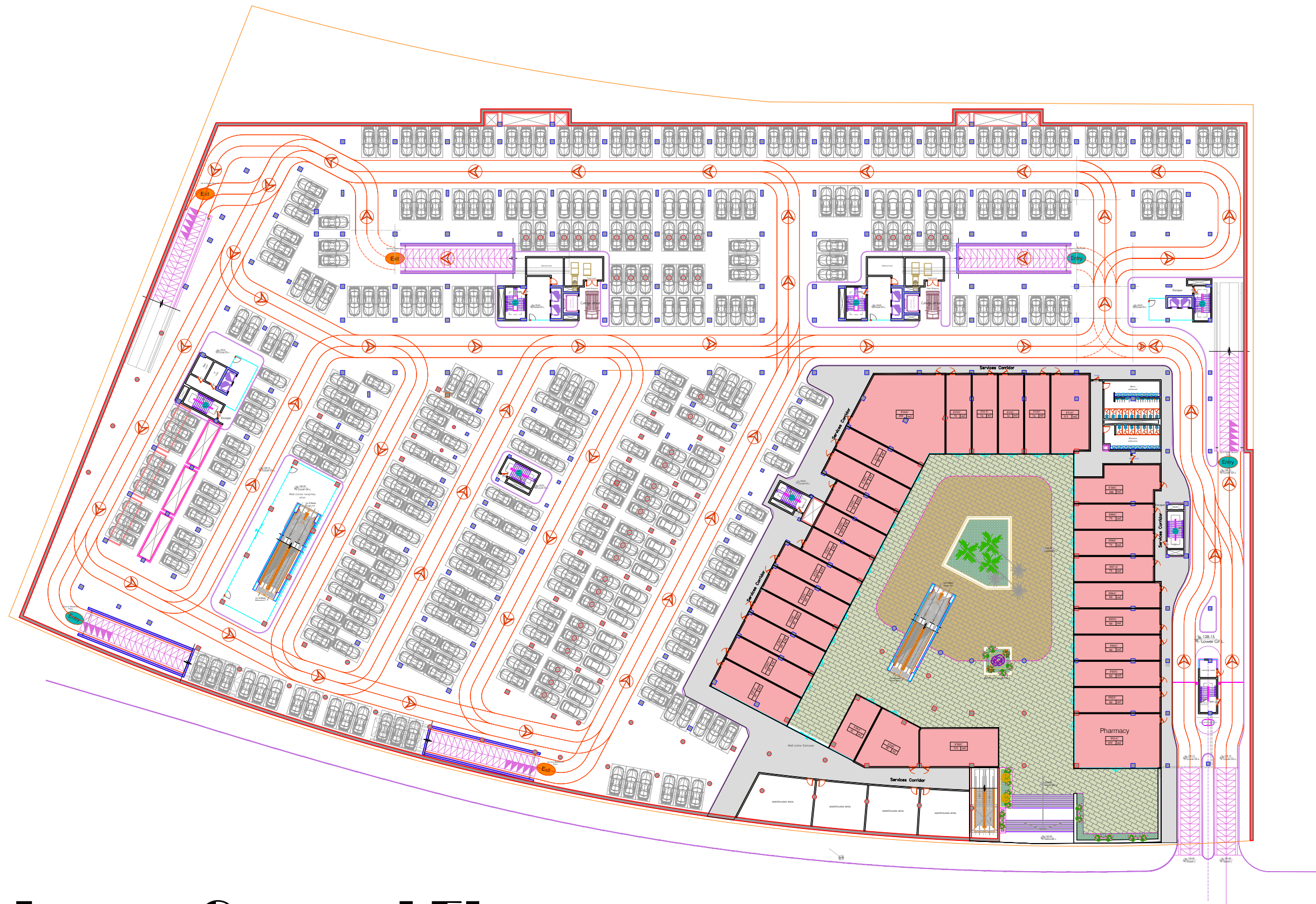

**Lower Ground Floor**



**Upper Ground Floor**



**First Floor**



**Second Floor**



**Third Floor**



**Fourth Floor**



**Fifth Floor**



**Sixth Floor**



CENTRADA™ *Rise*

THANKS

CENTRADA™ | NARRATIVE  
DEVELOPMENTS | COMMUNITIES

16634

CENTRADA-EGY.COM

